

Update for Board

January 22, 2020



Clean & Safe

- Successfully touched entire new district area
- Integrated our new equipment
- Working to add new staff





Engagement and Relationship Building

- 27 new drop in's and conversations
- New database
- Cultivating rapport and trust
- Hearing their needs

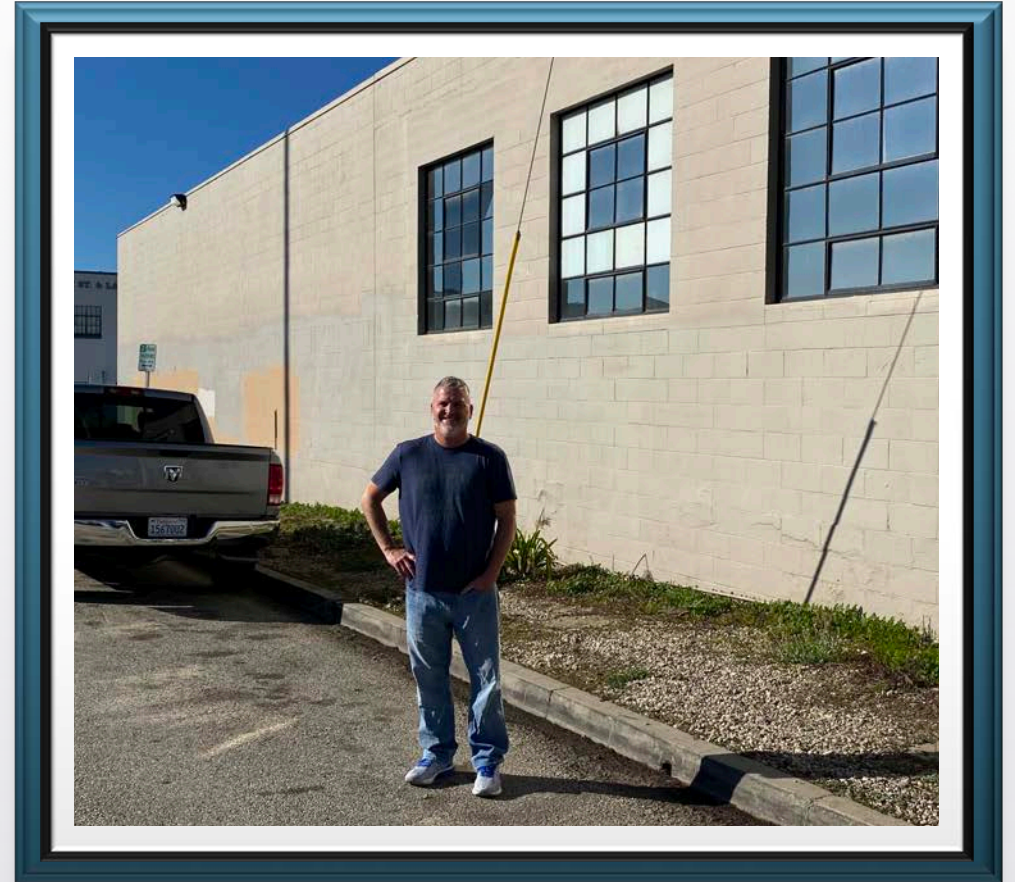

Placemaking

- Updates on active projects

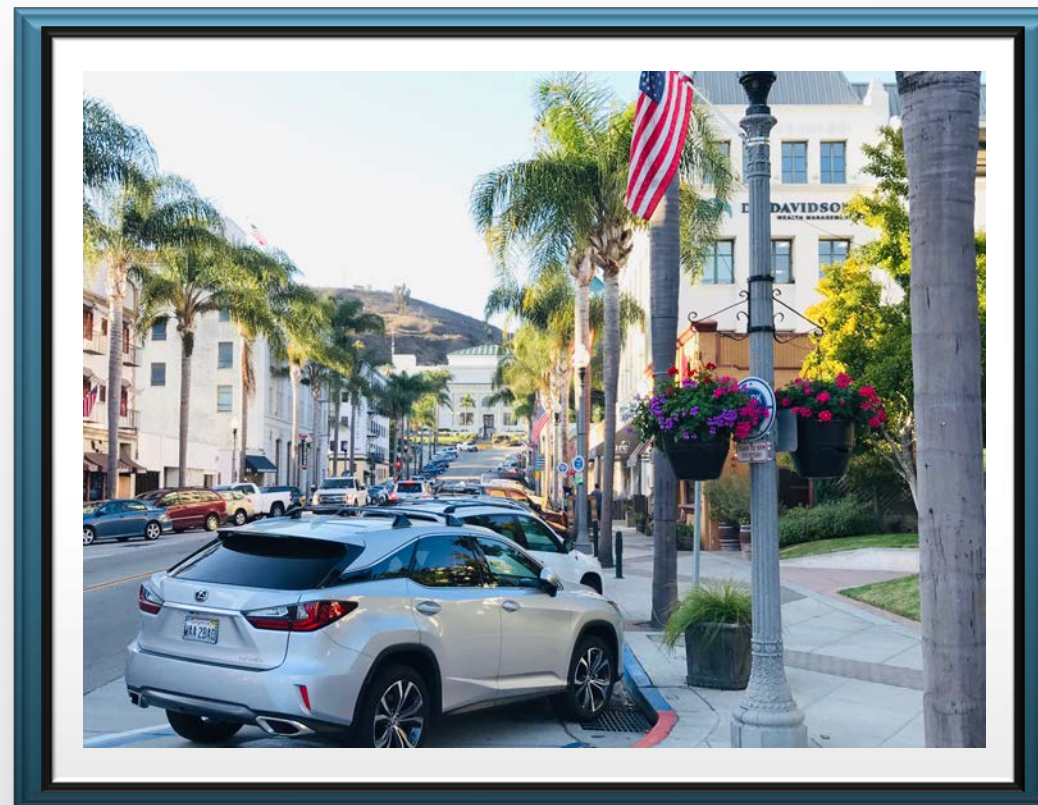



SAN BUENAVENTURA MISSION

MAIN STREET

10'

MUSEUM OF VENTURA COUNTY

MISSION PLAZA PARK

CONTOUR GRADING AND EXTEND
TURF TO NEW SIDEWALK

REMOVE EXISTING BUS STOP

9 NEW PARKING SPACES
(32 TOTAL PARKING SPACES)

REMOVE EXISTING TREES, &
RAISED PLANTERS, & SIDEWALK

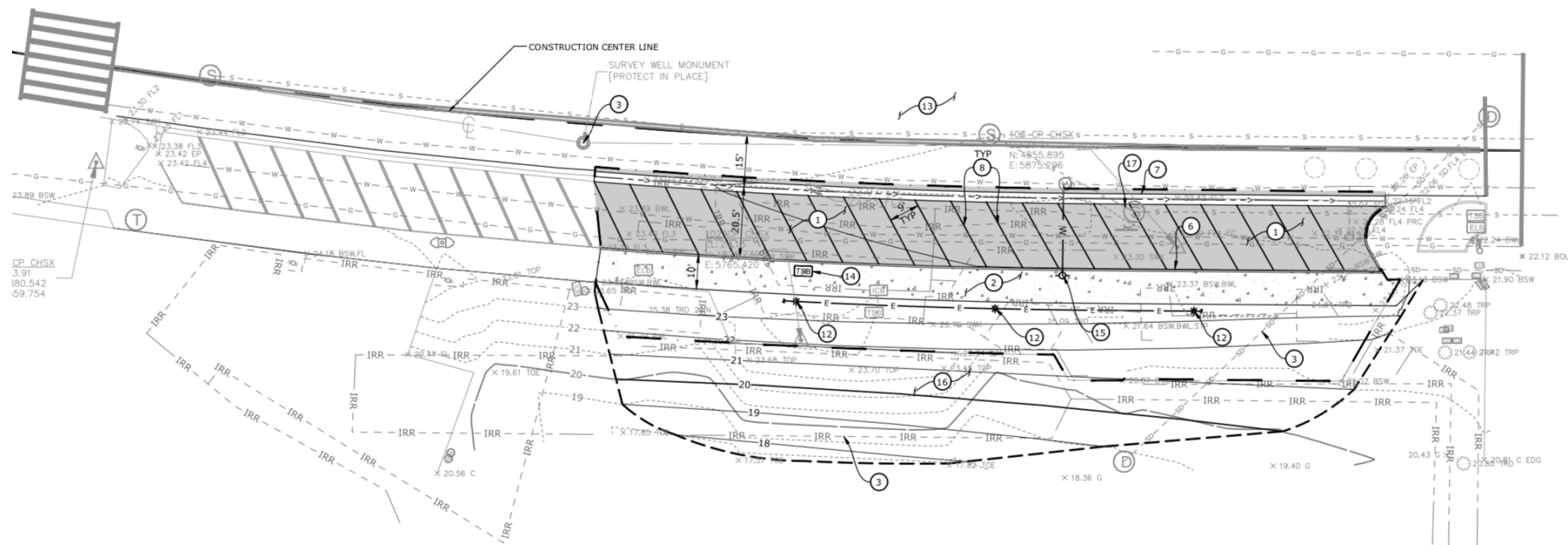









POLE MOUNT

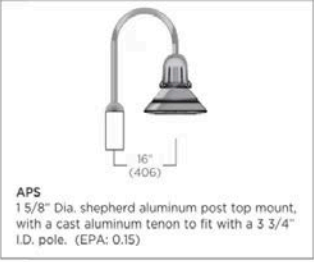
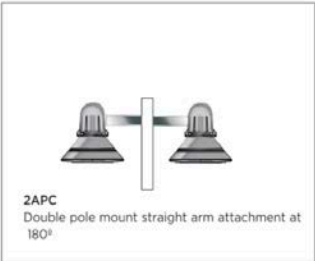
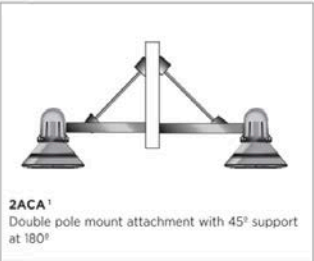
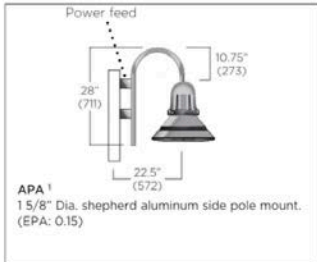
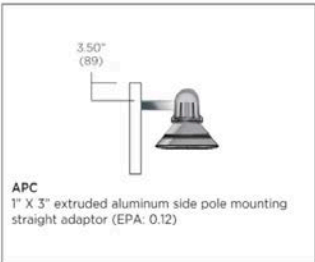
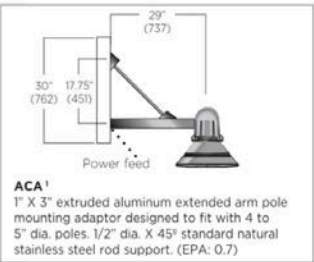

MATCHING POLE SELECTION

Ø 4"	Ø 5"	Ø 4"	Tapered Pole	Ø 4"	Height
PAA410	PAA510	PST10	-----	PSB10	10 Ft. (3 M)
PAA412	PAA512	PST12	-----	PSB12	12 Ft. (3,6 M)
PAA414	PAA514	PST14	-----	PSB14	14 Ft. (4,2 M)
PAA416	PAA516	PST16	PTA16	PSB16	16 Ft. (4,8 M)
PAA418	PAA518	-----	PTA18	PSB18	18 Ft. (5,5 M)
PAA420	PAA520	-----	PTA20	PSB20	20 Ft. (6,0 M)
-----	-----	-----	PTA25	-----	25 Ft. (7,6 M)

For additional pole details, please refer to separate pole specification sheet.
Ø 4"= 100mm Ø5"= 127mm











An aerial photograph of a city street intersection with a colorful, semi-transparent map overlay. The map shows a proposed botanical garden partnership area, which includes a paved plaza with orange and yellow diamond patterns, a large circular garden bed with a colorful floral design, and several green trees. A winding path leads through the garden area. The text "POTENTIAL BOTANICAL GARDENS PARTNERSHIP AREA" is written in the center of the map. The background shows a city street with cars and buildings.

POTENTIAL BOTANICAL
GARDENS PARTNERSHIP
AREA



SIDEWALK
CLOSED

STREETS

VTA STREETS

Promotion

- Social media
- Photographer
- Upcoming events
- Branding



Upcoming Events

- St. Patrick's Day Parade, Sat., March 14
- Spring Street Fair & Wine Walk, Sat., March 28
- Earthday Ecofest, Sat., April 25

2020 Priorities

- Successfully launch our daily Clean & Safe services in the expansion area.
- Continue to emphasize District wide cleanliness, particularly steam cleaning.
- Work with the CLUE Group to produce a Strategic Plan.
- Advance our parking goals related to the new parking structure and other plans in progress.
- Deploy the new Activation Manager to engage all existing and new stakeholders.
- Market Downtown as an authentic and activated cultural and retail space and increasingly residential hub of the community.



2020 Priorities

- Continue stewardship of the expanded Park Safety Ambassador Program, and seek to expand evening hours in summer.
- Organize and support high quality community events, and inform further refinements to the City Special Event permitting process.
- Support completion of the private-public alley improvements behind the Santa Clara parking structure.
- Support completion of JDA West's Haven apartment community and champion improvements to the pier/beach at South Ash Street.
- Partner with Code Enforcement to clean up newsracks and derelict or abandoned properties.

